

Wiring

Having correctly identified the wiring from your existing light fitting, connect to the approved IP67 (or higher rated) terminal block in the following way: (recommended terminal block ref. 61515)

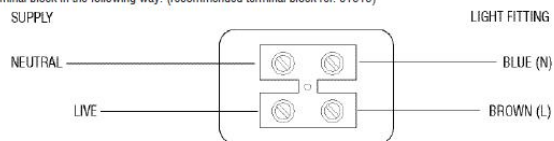

Check that...

- You have correctly identified the wires.
- The connections are tight.
- No loose strands have been left out of the terminals.

Care and Safety

- We recommend cleaning with a soft dry cloth. Do not use solvents or abrasive cleaners as these could damage the finish.
- For your safety, always switch off the supply before cleaning.

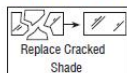

The LED module is protected by a shade. This part must be replaced immediately should the shade become cracked or damaged. This fitting must not be used without the shade in place.

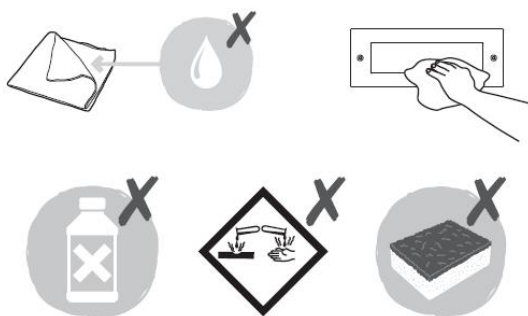

Instruction leaflet

Seina Recessed

78637, 78638, 78639, 78640, 78641



CE